

⚠ Caution | Do not mark on the model and other components with pen nor leave printed materials contacted on surface.
Ink marks on the models cannot be removed.

MW36

Vaginal Delivery Assistance Simulator

Instruction Manual

Contents

- Introduction P. 1
 Manufacturer's Note
- Before You Start P. 2
 Set Includes/ Precautions
- Handling and Storage P. 3
- Preparation P. 4 ~ P. 7
- Training P. 8 ~ P. 9
- After Training P. 10



Movie Site



English Site

Vaginal Delivery Assistance Simulator has been developed for advancing the skills in Midwifery, and facilitates the training in Vaginal Delivery Assistance.

■ Features

- The material of genitalia skin excels in elasticity, durability and resilience, and offers life-like realistic training skills from perineal protection to expulsion of fetus and placenta.
- It facilitate acquiring of skills based on the anatomical knowledge by observing the location of anatomically correct vaginal canal, ischia spine, pubic joint and pelvis.

■ Training Skills

- Delivery assistance for different delivery positions (dorsal, all-fours)
- Perineal protection, anal sphincter protection
- Delivery of fetus (forceps delivery, vacuum extraction)
- Clamping, tying and cutting of the umbilical cord
- Delivery of placenta
- Inspection of velamen
- Procedure of urinary catheterization

Read before use

Do not use this simulator for the other purpose. The manufacturer cannot be held responsible for any accident or damage resulting from any other use, or any use not in accordance with the enclosed instructions.

※ The new soft resin is employed for one of materials, which excels in elasticity, durability and resilience. The proper use and storage are required in accordance with the cautions in P.3 of this manual.

Set Includes

Before you start, ensure that you have all components listed below.



a. maternal body	1
b. genitalia unit	1
c. fetus	1
d. placenta	1
e. umbilical cord	1
f. umbilical cords for omphalotomy	3
g. velamen sheet	5
h. lubricant(500 ml)	1
i. talcum powder	1
j. Towelket	1
k. Vat	1
Instruction manual	1

Note : Please store it aware from high-temperature, humidity and direct sunlight.



DO' s and DON'Ts

● **Handle the manikin and the components with care.**

Be sure not to drop or add shock to the manikin and its components, since the product uses special resins and heavy, such shock may cause damage to the products or environment.

● **Do not let ink from pens, newspapers, this manual or other sources contact with the manikin, as they cannot be cleaned off the manikin skin.**

● **Storage in a dark, cool and dry space will help prevent the skin colors from fading and product from deforming.**

● **Never use organic solvent like paint thinner to clean the skin, as this will damage the simulator.**

● **The manikin skin may be cleaned with a wet cloth if necessary, using mildly soapy water or diluted detergent.**

● **Even if color on its surface might be changed across the ages, this does not affect the quality of its performance.**

PLEASE READ :

■ Always follow the handling and storage instruction below, to keep the material with its elasticity and durability.

○ AFTER USE

Apply talcum powder on the parts below, cover them with included storage bag or in a vat .



genitalia unit



placenta



umbilical cords for omphalotomy



○ Do not hold the placenta by holding an umbilical cord.

The placenta is to be stucked firmly on the flat place. Hold the placenta itself to move it to the other place.



○ Do not let the parts contact with other resin items and printed materials.

These soft material of the parts may be deformed by contact with other resin items and marked by contact with printed material and they cannot be repaired.

○ Maintain proper temperature, humidity and avoid direct sunlight of the storage room of simulators.

Be sure to monitor the indication sticker on the storage box of the product.

Store the simulator below 60 degrees C.

Change the storage place immediately when the temperature indicator shows color circles as below.

※The color circles are irreversible.

Before turned			After turned		
3F60	年	月貼付	3F60	年	月貼付
60	65	70	60	65	70

Preparation

Setting up the Fetus

1. Setting up the Fetus

Prepare the fetus, placenta, umbilical cord, umbilical cords for omphalotomy, velamen sheet, vat and lubricant.



Fetus



Placenta

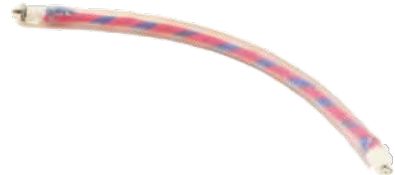

Umbilical Cord



Umbilical Cord
for Omphalotomy



Velamen Sheet



Vat



Lubricant

2. Take out the placenta from the storage bag to attach umbilical cord. Connect the screw side of umbilical cord to the placenta and turn it clockwise to fix.

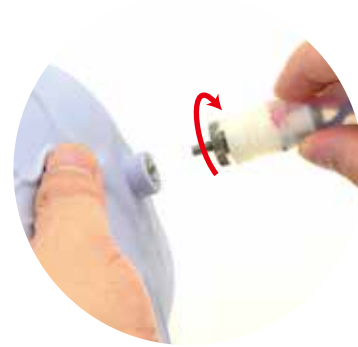

3. Insert the umbilical cord into the hole located at the center of the velamen sheet.



4. Take out the umbilical cord for omphalotomy from the storage bag. Reverse the tip of it to show the hook, and engage it to the hook at the umbilical cord from the placenta.



Attach the umbilical cord

5. Loosen the screw in the abdomen of the fetus and take out the clip inside.

※If the clip is difficult to take out, hold the fetus abdomen downwards and the clip will fall out.

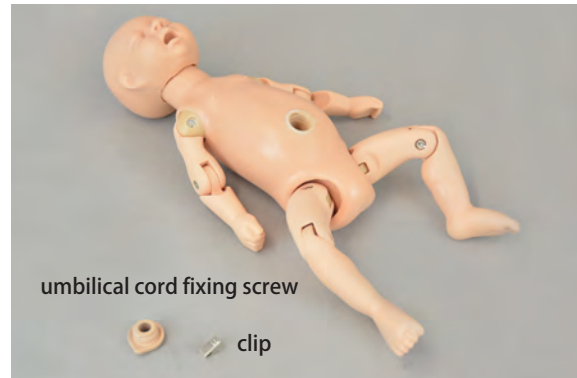
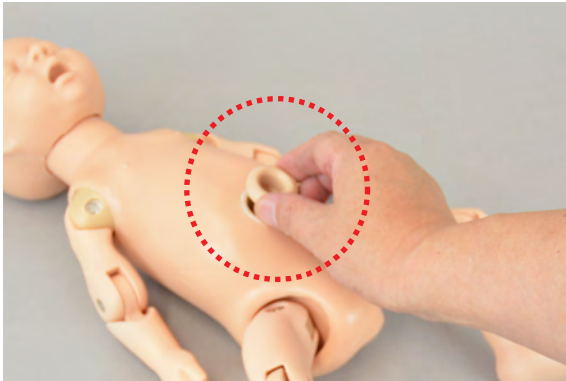

6. Thread the umbilical cord through fixing screw, then clip the tip.

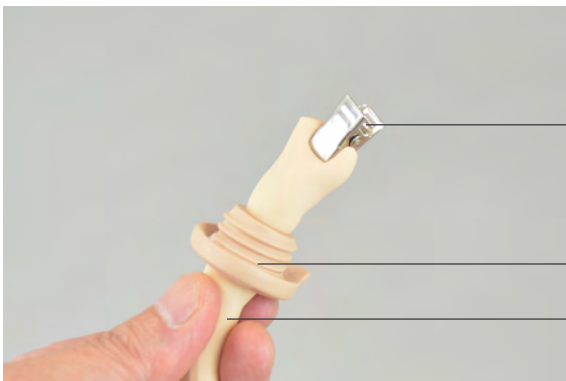

clip

umbilical cord fixing screw

umbilical cord for omphalotomy

7. Insert the clip back to the abdomen of the fetus and tighten the screw.



8. The fetus is ready.



※When tightening, if the clip hits the fixing screw, it cannot be tightened completely.

※Adjust the clip direction to avoid hitting fixing screw.

Preparation

Lubrication

Before training, apply lubricant to the genitalia unit, placenta, and umbilical cords for omphalotomy completely.

1. Put the assembled fetus in the vat included in the set. Apply lubricant to it entirely including the velamen sheet and the placenta.



2. Apply lubricant to the internal surface of the genitalia unit, too.

※The genitalia unit can be lubricated after attaching to the maternal body.



Assembly of the Maternal Body

1. Remove the abdominal cover from the body. The abdominal cover and body are attached with four magnets. The abdominal cover can be removed by lifting.

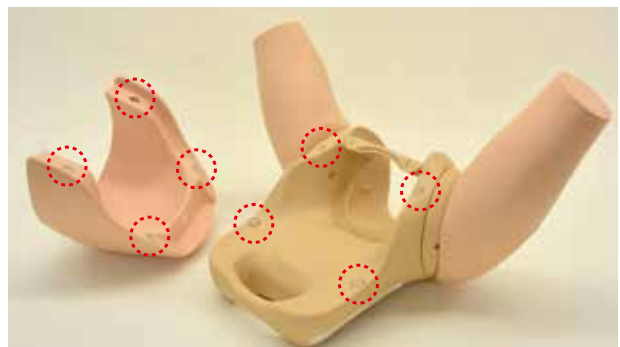

Preparation

Assembly of the Maternal Body

2. Attach two nails of genitalia unit to two pits located under part of maternal body, and push on the top of the unit to fix.

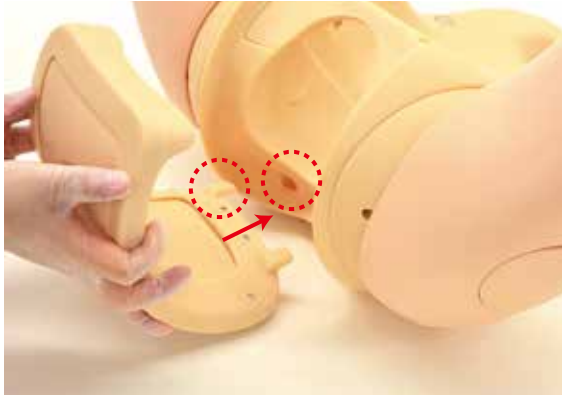

* Be careful not to pinch your finger between the maternal body and the genitalia unit.

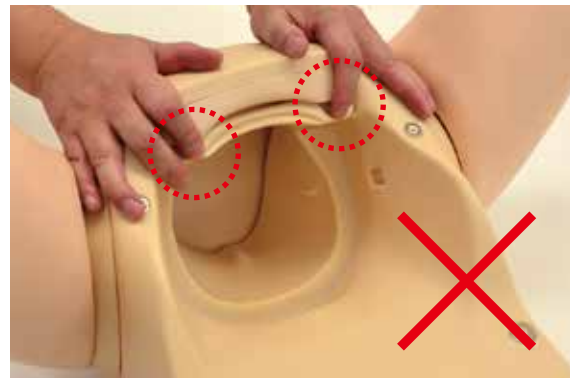

3. Put back the abdominal cover to the maternal body, and set the fetus in it to complete set-up.

* Always put the placenta on the vat during the training.



Key Features

Training can be conducted in two birth positions: dorsal and all-fours position.



Dorsal position



All-fours position

《Key Features》

- Direct observation of the motion of fetus in delivery to understand the spatial relationship between pelvis and fetus.
- Genitalia unit has excellent elasticity and resilience and birth canal is optimal size for the fetus, which allows to deliver the fetus by a little pushing force holding the handle lightly.
- Pelvis has pubic symphysis and ischial spines, which facilitates understanding of the spatial relationship between pelvis and fetus.

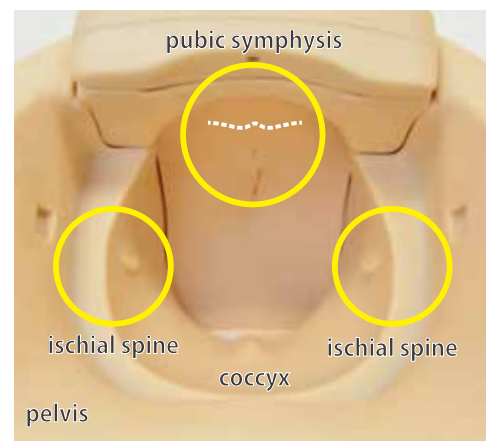

Station zero, the line that connect ischial spines can be recognized.

Training skills

- Perineal protection



- Delivery assistance



- Delivery of fetus



- Clamping, tying and cutting of umbilical cord



- Delivery of placenta



- Inspection of velamen and placenta



After Training

○ Remove the genitalia unit

1. Lift the abdominal cover to remove it from the maternal body.



2. Pull back the top of the genitalia unit frame to remove from the body.



○ Disassembling the fetus

1. Disengage the umbilical cord and placenta in reverse order of set-up. (See P.4-P.5)

○ Cleaning and storage

1. Wipe the lubricant left on the fetus, umbilical cord, placenta and genitalia unit away with wet paper tissue. If necessary, wash them by tap water, and dry them well naturally. After completely dried the components, apply talcum powder to each of them.



2. Genitalia unit, placenta and umbilical cord for omphalotomy are made of special soft resin. It is required to store them either in the storage bag or on the vat after training.

※If these parts are stored touching with other resin products or printed matter, the dent or ink might be left on the skin, and will become irremovable.





Caution

Do not mark on the model and other components with pen nor leave printed materials contacted on surface. Ink marks on the models cannot be removed.

Replacement parts

Code	Name	Code	Name
11415-030	1 genitalia unit (for pelvic examination and delivery assistance)	11416-030	10 umbilical cords for omphalotomy
11458-030	1 fetus	11416-040	5 velamen sheets
11416-020	1 placenta	11415-040	1 lubricant (500ml) refill bag
		11415-050	1 lubricant (500ml) refill bag and bottle



1 genitalia unit
(for pelvic examination and delivery assistance)



1 fetus



1 placenta



10 umbilical cords for omphalotomy



5 velamen sheets



lubricant (500ml) refill bag and bottle

Optional Parts

Code	Name
11417-020	genitalia unit (for perineorrhaphy)



genitalia unit
(for perineorrhaphy)

For inquiries and service, please contact your distributor or KYOTO KAGAKU CO., LTD.

The contents of the instruction manual are subject to change without prior notice.

No part of this instruction manual may be reproduced or transmitted in any form without permission from the manufacturer.

Please contact manufacturer for extra copies of this manual which may contain important updates and revisions.

Please contact manufacturer with any discrepancies in this manual or product feedback. Your cooperation is greatly appreciated.

■ Main Office and Factory (World Wide)

 **KYOTO KAGAKU co.,LTD**

WEB • www.kyotogagaku.com

E-MAIL • rw-kyoto@kyotokagaku.co.jp

15 kitaneokoya-cho Fushimi-ku Kyoto 612-8388, Japan

TEL : +81-75-605-2510

FAX : +81-75-605-2519

■ North and South American regions:

North and South American regions:

 **KKAmerica**

WEB • www.kkamerica-inc.com

E-MAIL • info@kkamerica-inc.com

3109 Lomita Boulevard, Torrance, CA 90505-5108, USA

TEL: +1-310-325-8860

(Toll-free in North America: 877-648-8195)

FAX: +1-310-325-8867