

# Epidural Anesthesia Simulator

Read the full instruction manual carefully before use.

## 1 Connect the block to the drain pouch

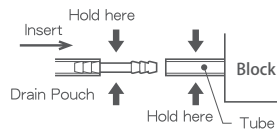
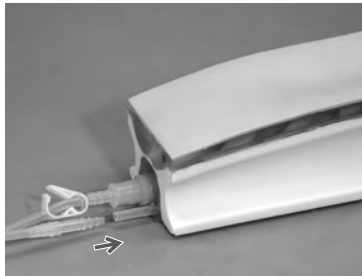

- 1) Ensure that the drain pouch is empty.
- 2) Hold the side tube of the puncture block and connect it to the connector of the drain pouch.

## 2 Connect the puncture block to the syringe

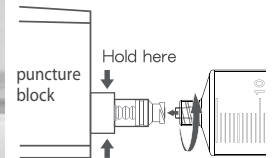
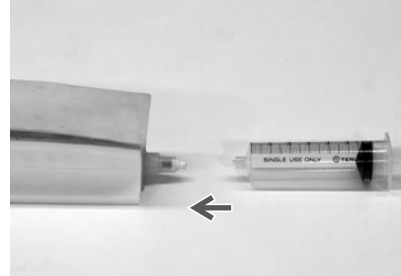

- 1) Fill the syringe with water.
- 2) Connect the tip of the syringe to the connector at the end of the block by screwing it clockwise.

## 3 Fill the Block with water

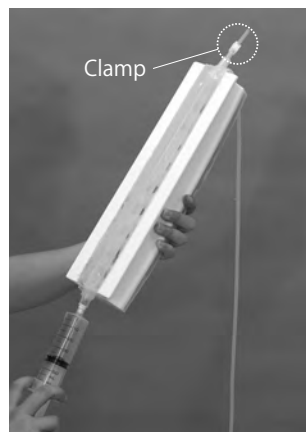

- 1) Open the clamp on the tube.
- 2) Hold the block upright with the open end of the tube upwards.
- 3) Push in the piston of the syringe and fill the block with water (approx. 25cc).
- 4) When the water surface reaches above the clamp, close the clamp firmly.
- 5) Unscrew the syringe.

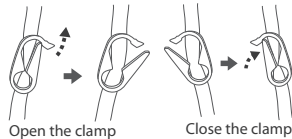

## 4 Set the block in the model



Put the block into the pit on the model so that the tube with clamp comes to the head side of the torso.

## 5 Set the body position



Set the supporting stand on the head side of the torso to keep it at (right or left) lateral position.

## 6 Ready

