

PH-29

ECT Hot Cold Phantom SP-6 specifications

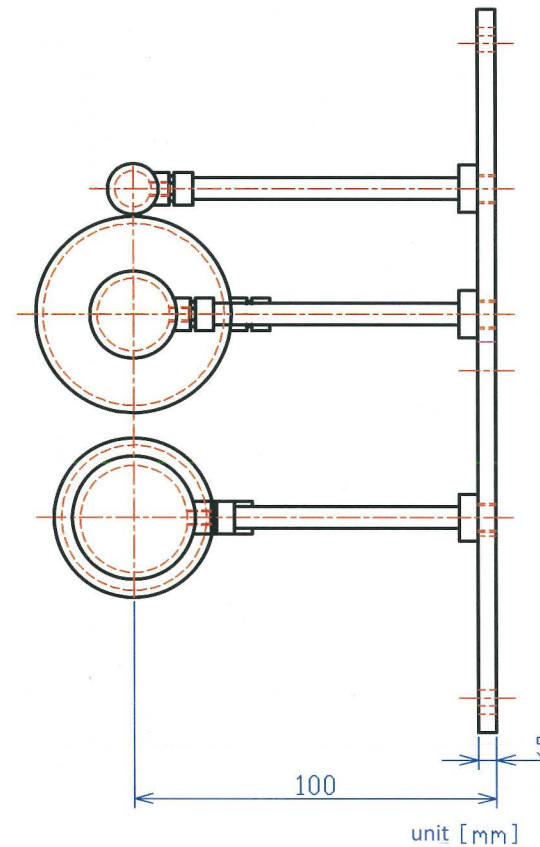
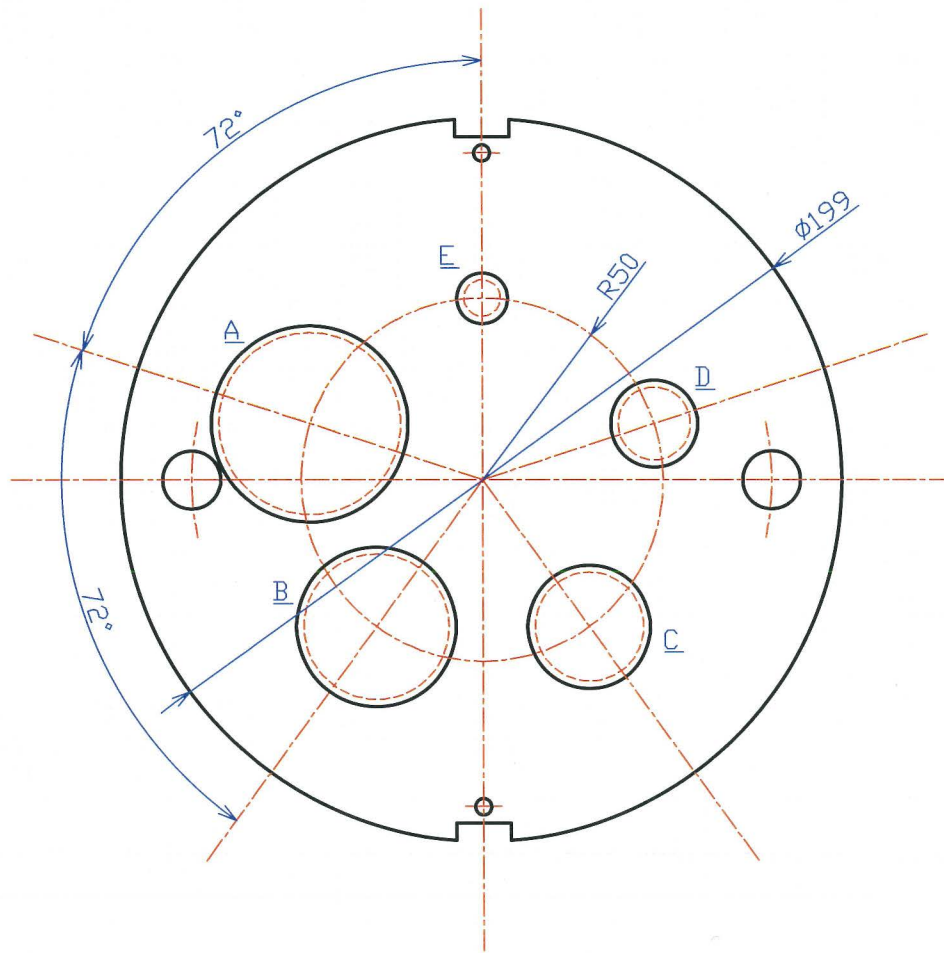

round container

|   | inner diameter (mm) | volume (cc) |
|---|---------------------|-------------|
| A | 50                  |             |
| B | 40                  |             |
| C | 30                  |             |
| D | 20                  |             |
| F | 10                  |             |

Wall thickness 2mm

◦ Every sphere's volume's pixel count can be confirmed and volume measurement reproducibility can be evaluated.

PH-29

ECT Hot Cold Phantom SP-6 specifications

## ■ USA, Canada, and South America



**WEB** • [www.kkamerica-inc.com](http://www.kkamerica-inc.com)

**E-MAIL** • [info@kkamerica-inc.com](mailto:info@kkamerica-inc.com)

**TEL** : 1-310-325-8860 **FAX** : 1-310-325-8867

3109 Lomita Boulevard, Torrance, CA 90505-5108, USA

## ■ Europe, Russia & Africa

### **Kyoto Kagaku Europe GmbH.**

**TEL** : +49-69-5060-28160

De-Saint-Exupery-Str.10,60549 Frankfurt, Germany

## ■ Worldwide Inquiries and Orders

### **KYOTO KAGAKU co.,LTD**

**URL**: <http://www.kyotokagaku.com> **e-mail**: [rw-kyoto@kyotokagaku.co.jp](mailto:rw-kyoto@kyotokagaku.co.jp)

**TEL** : +81-75-605-2510 **FAX** : +81-75-605-2519

15 Kitanechoya-cho, Fushimi-ku, Kyoto, 612-8388, JAPAN

---

The contents of the instruction manual are subject to change without prior notice.

No part of this instruction manual may be reproduced or transmitted in any form without permission from the manufacturer.

Please contact manufacturer for extra copies of this manual which may contain important updates and revisions.

Please contact manufacturer with any discrepancies, typos, or mistakes in this manual or product feedback. Your cooperation is greatly appreciated.