

# Ladder Phantom

Instruction  
manual

## Contents

- General Information
  - Precaution . . . . . P.1
  - Specifications . . . . . P.2

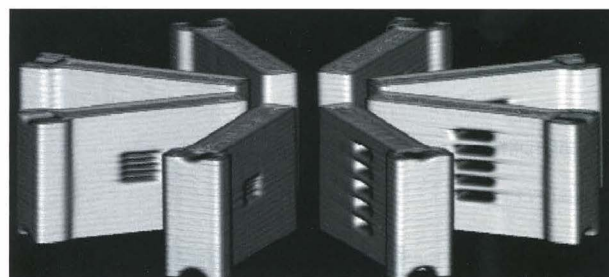
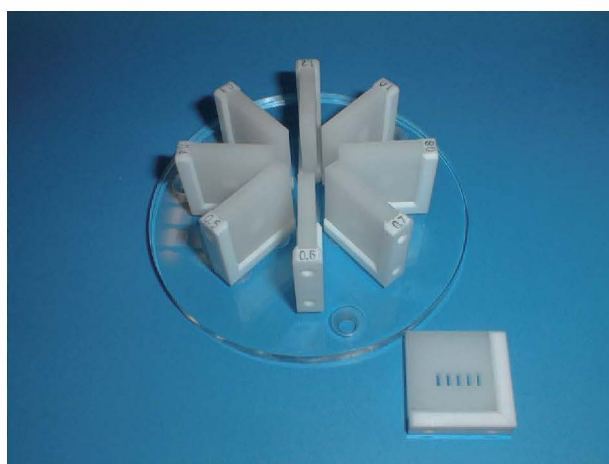

## Set includes

Before use, make sure that all components are there.



a

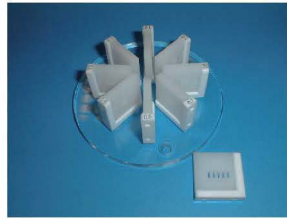

b



Fixation (left: for GE devices  
right: for Toshiba devices)

\*there is one fixation for every device maker  
c

a	Cylindrical phantom (including screws)	1
b	Measurement blocks (9 pcs.) and base	1 set
c	Fixations	1
	Plus screwdriver	1
	Vaseline	1
	Replacement screws	1 set
	Storage case	1

## ⚠ Caution

- **Handle the manikin and the components with care.**

As the material is from hard resin, please refrain from dropping it or to hit it with a hard object.

- **Only use water or neutral detergent to wipe the phantom.**

Never use organic solvents such as paint thinner to clean the phantom.

- **Please keep away from high temperature and humidity.**

After use please store it in a cool and dry space away from the sun, to prevent deformation or the malfunction of the phantom.

- **Don't use felt pen or marker on this phantom.**

In this case the ink could leave stains on the phantom.

## ● Installing the phantom

Material: Acrylic resin

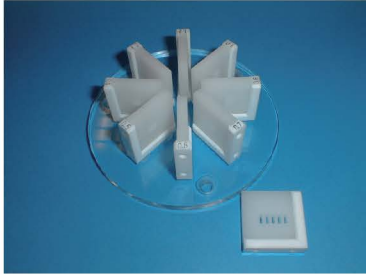

- 1 Place the measurement blocks as well as the base into the cylindrical phantom.



- 2 Remove the 2 resin plugs on the lid and fill the phantom with water completely, so that there is no air left. Close with plugs after filling.

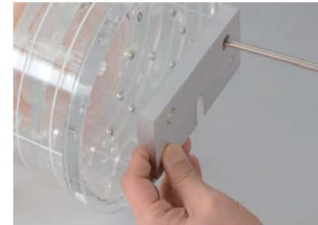

- 3 Connect the fixation to the bottom of the phantom.

### Specifications

Slit width: 9 variations (0.3, 0.4, 0.5, 0.6, 0.7, 0.8, 1.0, 1.2, 1.5mm)

Slit length: 5mm

Slit quantity: 5

Block thickness: 5mm

Material: epoxy resin and hydroxyapatite (measuring block)  
acrylic resin (base)

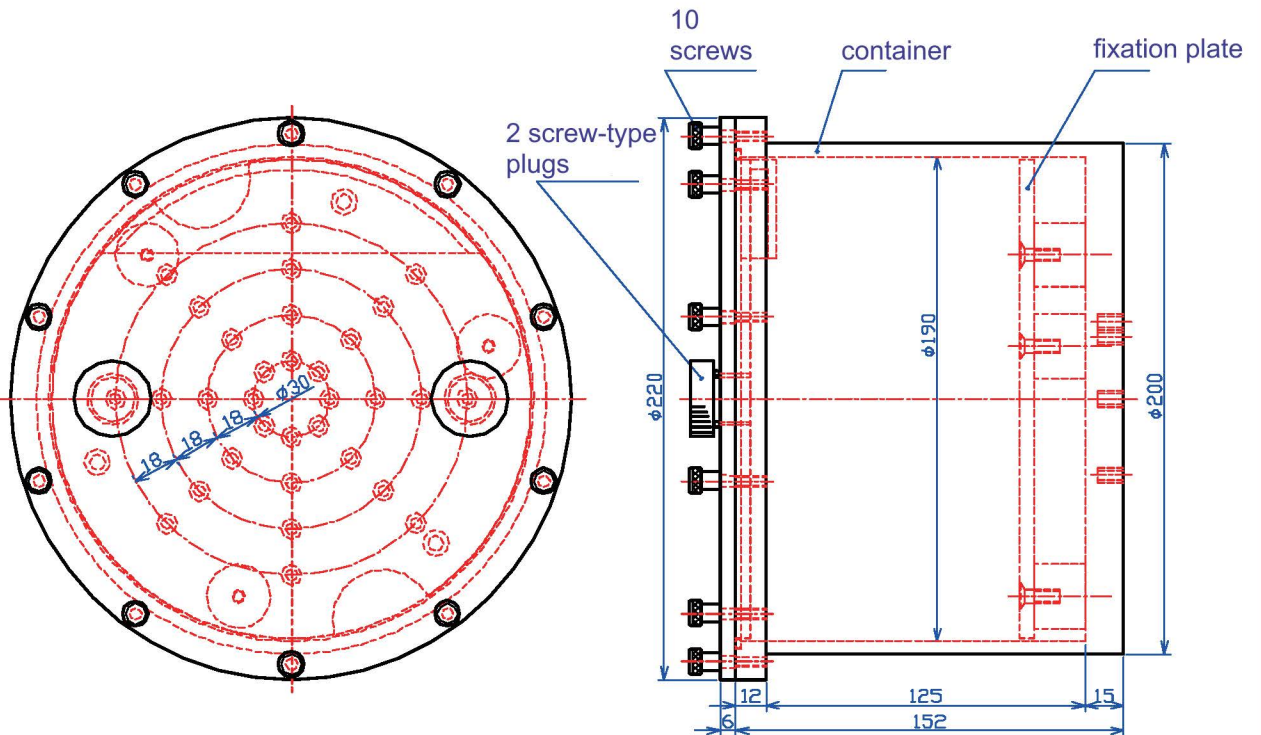

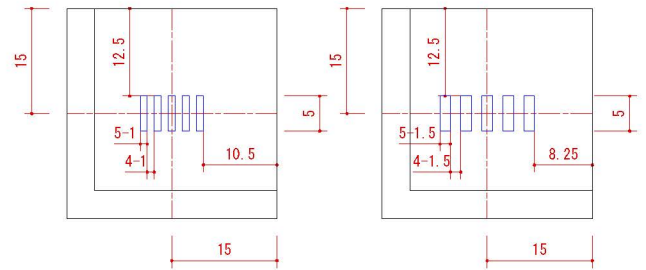
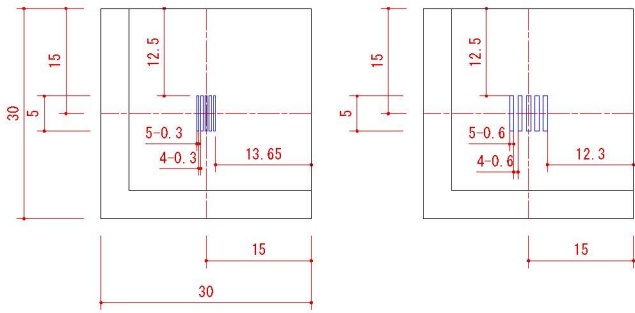
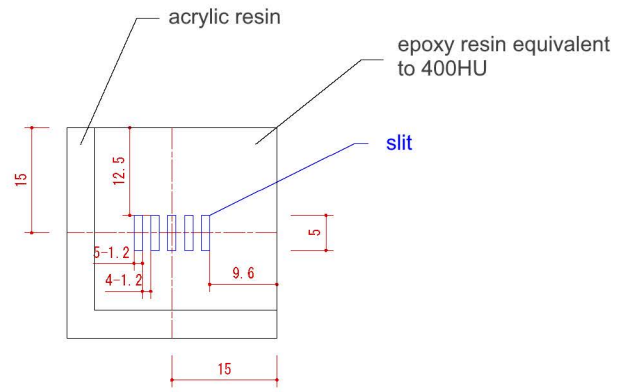
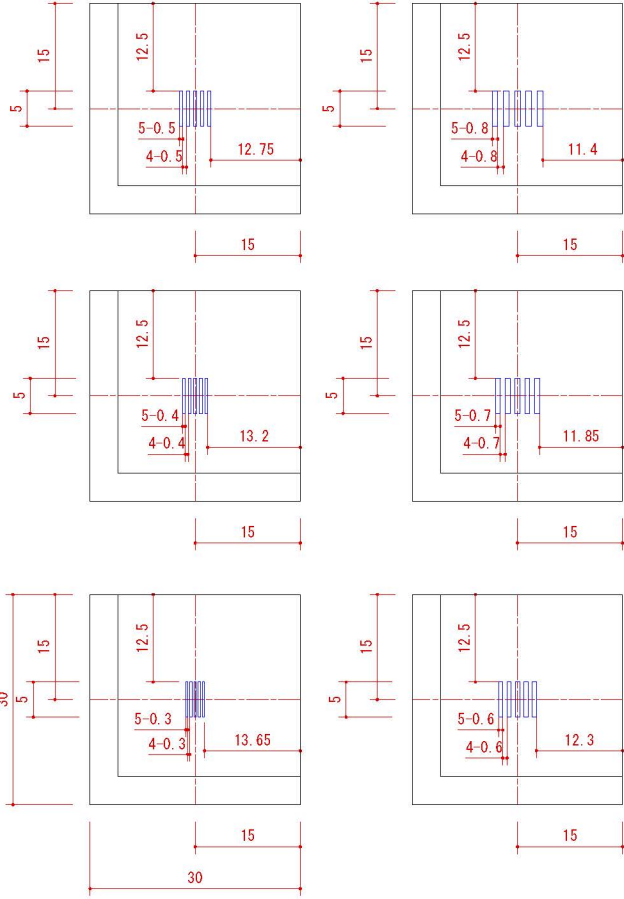

## ■ USA, Canada, and South America



**WEB** • [www.kkamerica-inc.com](http://www.kkamerica-inc.com)

**E-MAIL** • [info@kkamerica-inc.com](mailto:info@kkamerica-inc.com)

**TEL** : 1-310-325-8860 **FAX** : 1-310-325-8867

3109 Lomita Boulevard, Torrance, CA 90505-5108, USA

## ■ Europe, Russia & Africa

### **Kyoto Kagaku Europe GmbH.**

**TEL** : +49-69-5060-28160

De-Saint-Exupery-Str.10,60549 Frankfurt, Germany

## ■ Worldwide Inquiries and Orders

### **KYOTO KAGAKU co.,LTD**

**URL**: <http://www.kyotokagaku.com> **e-mail**: [rw-kyoto@kyotokagaku.co.jp](mailto:rw-kyoto@kyotokagaku.co.jp)

**TEL** : +81-75-605-2510 **FAX** : +81-75-605-2519

15 Kitanechoya-cho, Fushimi-ku, Kyoto, 612-8388, JAPAN

---

The contents of the instruction manual are subject to change without prior notice.

No part of this instruction manual may be reproduced or transmitted in any form without permission from the manufacturer.

Please contact manufacturer for extra copies of this manual which may contain important updates and revisions.

Please contact manufacturer with any discrepancies, typos, or mistakes in this manual or product feedback. Your cooperation is greatly appreciated.